

# GREATER FORT LAUDERDALE BROWARD COUNTY



greater  
**fort lauderdale**  
alliance | broward  
county  
*Life. Less taxing.*



06.07.23



# THE CENTER OF SOUTH FLORIDA



FOR

Nearly

**2M**

Total Residents

**+132K**

10-Year Growth

**\$92,900**

Average Household Income

**\$127B GDP**

Larger than 14 States  
24% growth in 5 years

# FLL - INTERNATIONAL AIRPORT

**32M**

Annual Passengers

U.S. Rankings:

**#11th** International passengers

**#17th** Total passengers

**#20th** Domestic passengers

**83**

International  
Departures - Daily

**50**

International  
Destinations in 22  
Countries





# 2023 ULI EMERGING TRENDS IN REAL ESTATE MAGNETS: 18-HOUR CITY

**FORT LAUDERDALE**

**SAN DIEGO**

**PORTLAND**

**SALT LAKE CITY**

**MINNEAPOLIS**

**DENVER**

**CHARLOTTE**



DowntownFTL has built more rental units over the past 5 years than downtown Austin and downtown Atlanta **combined**.



Source: Fort Lauderdale Downtown DDA

# DOWNTOWN FORT LAUDERDALE



**46+**

Planned Projects

**17K+**

Total Units

**Aimco**  
Searstown



## Convention Center

800 Room Omni Hotel

1.2M SF of New Convention Space



**BH3**  
DNA



Source: Fort Lauderdale Downtown DDA

**Naftali Group**  
201 N Federal Hwy





**Merrimac Ventures**  
317 N Federal



Source: Fort Lauderdale Downtown DDA

**Dependable Equities**  
Ombelle

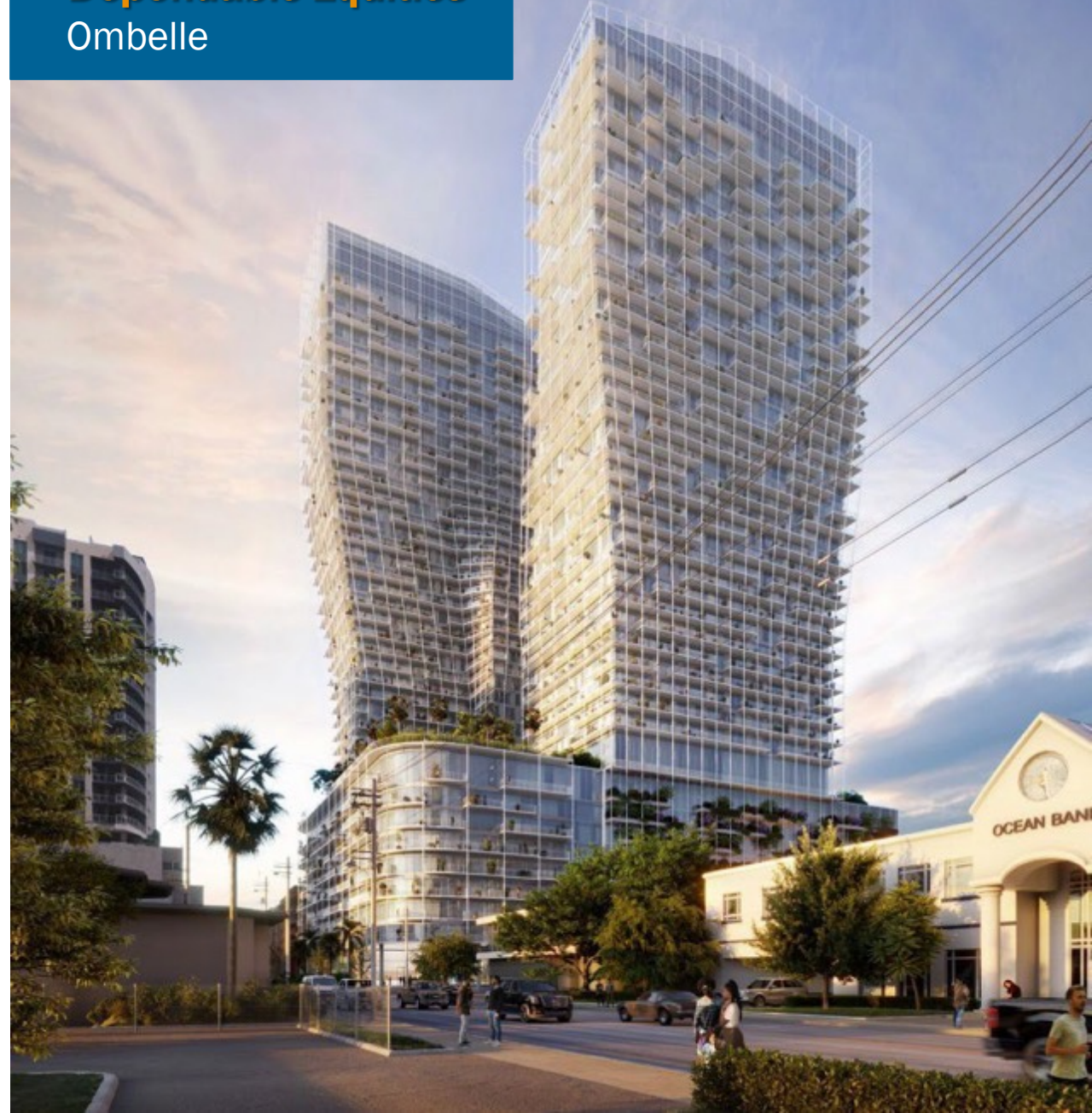

# FLAGLER VILLAGE



**20**

Planned Projects

**8K+**

Total Units

**Hines &  
Urban Street Development**  
T3 FAT Village



**New Leaf**  
The Muse | 112 Units



Source: Fort Lauderdale Downtown DDA

**Jefferson Apartment Group**  
Flagler Creative



**Related Group & Broward County**  
The Gallery at Flagler Village



Source: Fort Lauderdale Downtown DDA

**Prospect Real Estate Group**  
Advantis Station





# GREATER FORT LAUDERDALE COMPANIES





**West Marine**

**chewy**



**SOLOMON PARTNERS**



**üKG**



**JPMORGAN CHASE & CO.**



**ELZVALTXE**

**HEICO®**



# THANK YOU

## CONTACT INFORMATION:

David Coddington  
SVP - Business Development  
954-627-0123  
[dcoddington@gflalliance.org](mailto:dcoddington@gflalliance.org)  
[www.gflalliance.org](http://www.gflalliance.org)